

INTERLOCKING SAFETY SWITCHES

Features

- Galvanically separated contacts
- Screw terminals with self-lifting clamps for easy wiring
- Positive Opening of NC contacts
- 4 x 90° actuator positions
- Horizontal or Vertical Operation

Definitions of Operating Characteristics

OF	Operating Force
RF	Releasing Force
OT	Overtravel
TT	Total Travel
PT	Pretravel
MD	Movement Differential
OP	Operating Position
PO	Travel to Positive Opening



Specifications

Operating Speed	0.05mm-0.5m/s
Operating Frequency	Mechanical: 120ops/min Electrical: 30 ops/min
Insulation Resistance	>100MΩ@500V DC
Contact Resistance	<25mΩ (initial value)
Rated Current/Voltage	10A/600V AC (EN60947-5-1) AC15 A600 / DC13 Q300
Dielectric Strength	1000VAC for 1 min between current carrying parts 2500VAC for 1 min between non-current carrying parts
Service Life	Mechanically 1.0 x 10 ⁷ (operations) Electrically 5 x 10 ⁵ (operations)
Operating Temperature	-25~+80°C (-13~176°F)
Humidity	< 95%
Degree of Protection	IP67/ IP66(SMN4)

Plastic-Bodied Interlock Safety Switch

Selection Guide

SND2191

- Body Type
- SND2191 Mini Plastic Body, 2 Conduit
- SMN4191 Plastic Body, 1 Conduit
- SND4191 Plastic Body, 1 Conduit
- SND6191 Large Plastic Body, 1 Conduit
- SN6191 Metal Body, 1 Conduit
- SN6291 Metal Body, 1 Conduit
- SN6391 Metal Body, 3 Conduit

SL

- SL: 1NO/1NC Slow Action Changeover
- SL2: 2NC Slow Action
- SL7: 2NC/1NO Slow Action Overlapping

C

- Conduit
- A: 1/2"NPT
- B: PG13.5
- C: M20
- D: M16
- B1: PG11

SND2191



SND2191-SL

Slow Action (Changeover)

1NO/1NC

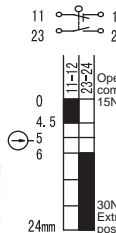

SND2191-SL2

Slow Action

2NC

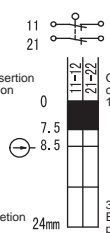

SND2191-SL7

Slow Action (Overlapping)

2NC/1NO

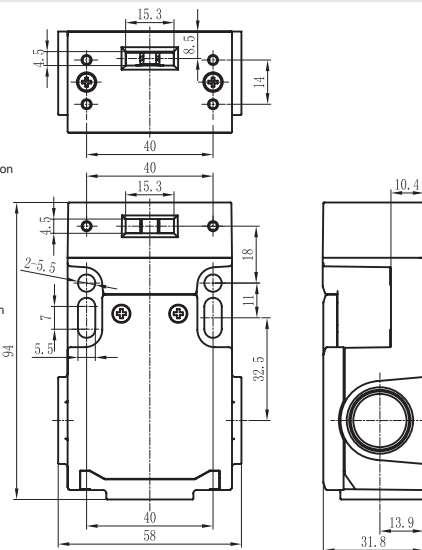
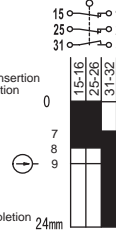

Order Code

Contact block

SND2191-SL- _	SL		slow action	1NO+1NC	BBM
SND2191-SL2- _	SL2		slow action	2NC	
SND2191-SL7- _	SL7		slow action	2NC/1NO	MBB

INTERLOCKING SAFETY SWITCHES

SMN4191

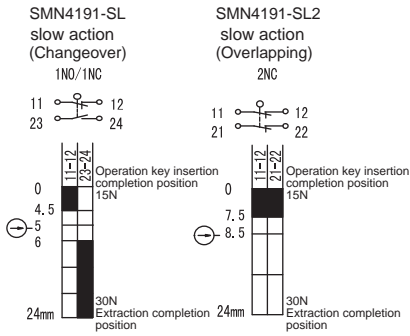

Order Code

Contact block

SMN4191-SL- _	SL		slow action	1NO+1NC	BBM
SMN4191-SL2- _	SL2		slow action	2NC	

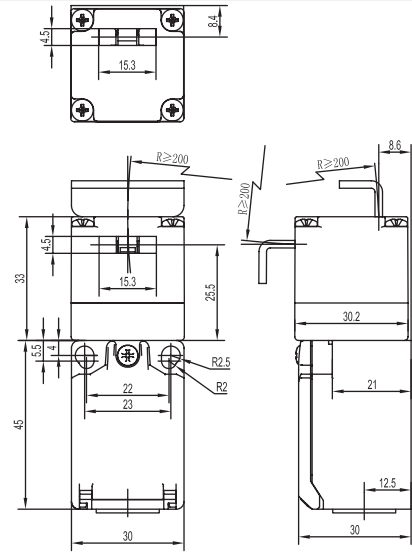

SND4191

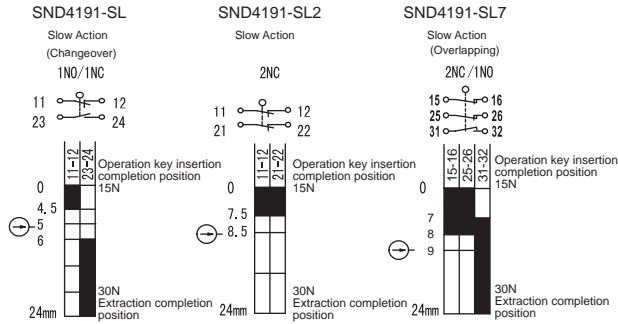

Order Code

Contact block

SND4191-SL- _	SL		slow action	1NO+1NC	BBM
SND4191-SL2- _	SL2		slow action	2NC	
SND4191-SL7- _	SL7		slow action	2NC/1NO	MBB

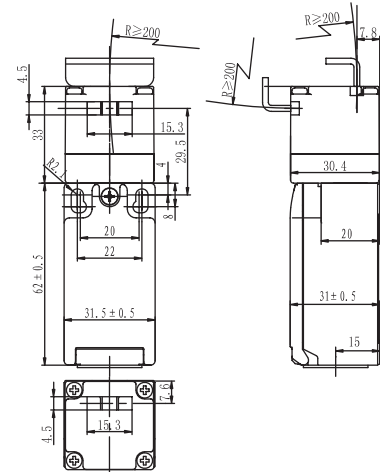

SND6191

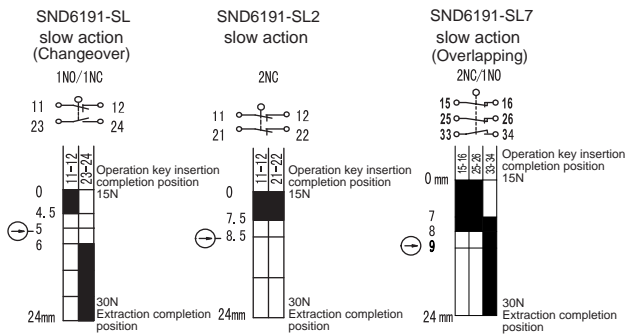

Order Code

Contact block

SND6191-SL- _	SL		slow action	1NO+1NC	BBM
SND6191-SL2- _	SL2		slow action	2NC	
SND6191-SL7- _	SL7		slow action	2NC/1NO	

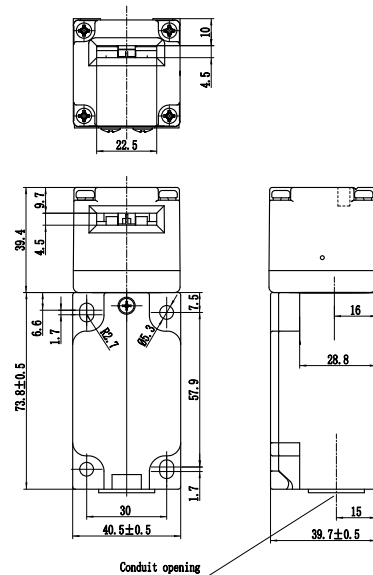

INTERLOCKING SAFETY SWITCHES

SN6191 Metal Enclosure, Metal Head

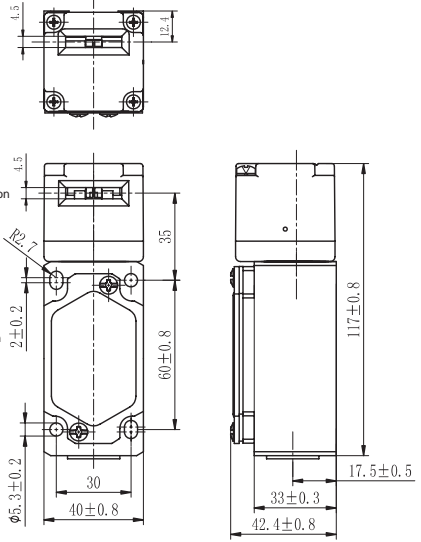
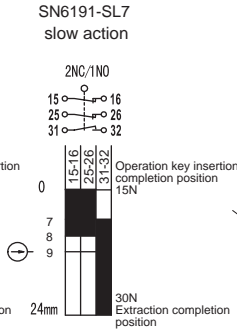
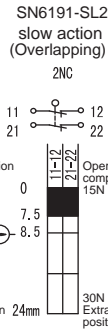
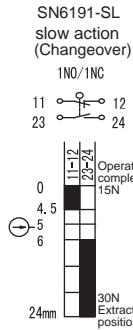

Order Code	Contact block			
SN6191-SL- _	SL		slow action	1NO+1NC BBM
SN6191-SL2- _	SL2		slow action	2NC
SN6191-SL7- _	SL7		slow action	2NC/1NO

SN6291 Metal Enclosure, Metal Head

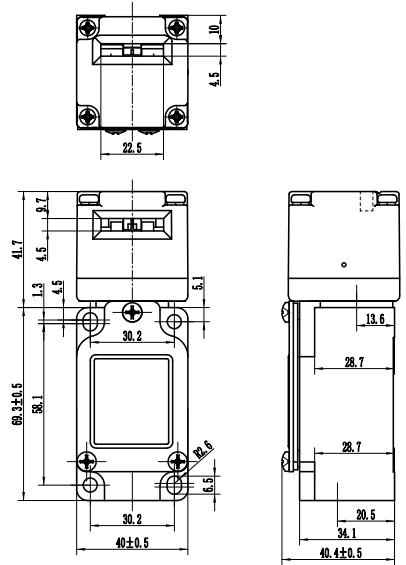
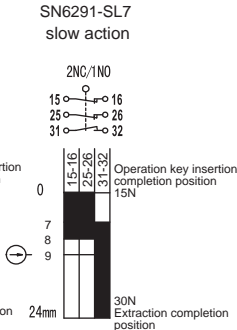
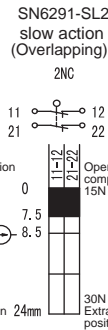
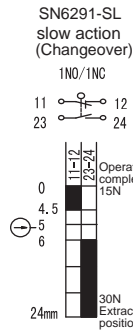

Order Code	Contact block			
SN6291-SL- _	SL		slow action	1NO+1NC BBM
SN6291-SL2- _	SL2		slow action	2NC
SN6291-SL7- _	SL7		slow action	2NC/1NO

SN6391 Metal Enclosure, Metal Head

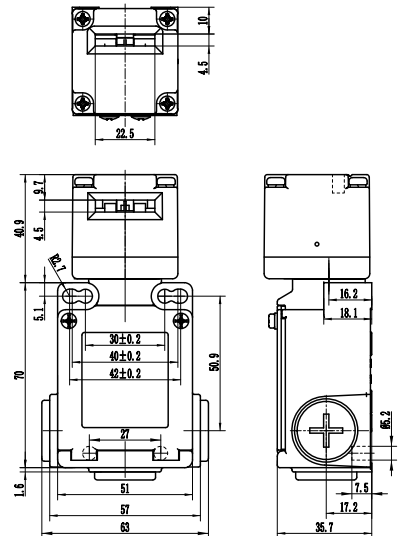
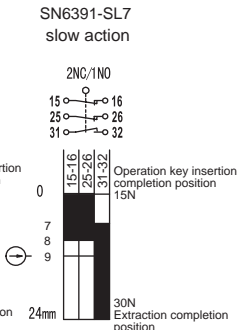
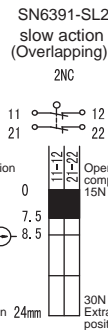
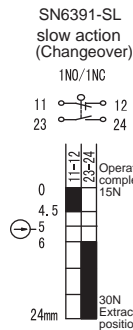

Order Code	Contact block			
SN6391-SL- _	SL		slow action	1NO+1NC BBM
SN6391-SL2- _	SL2		slow action	2NC
SN6391-SL7- _	SL7		slow action	2NC/1NO

INTERLOCKING SAFETY SWITCHES KEY

SN6-K1

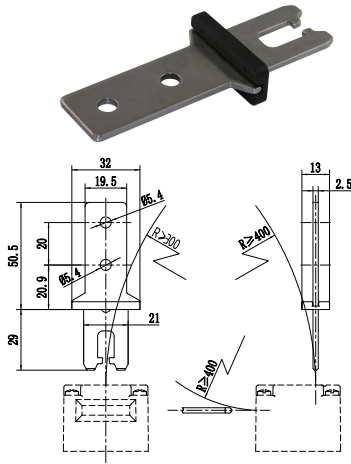

SN6-K2

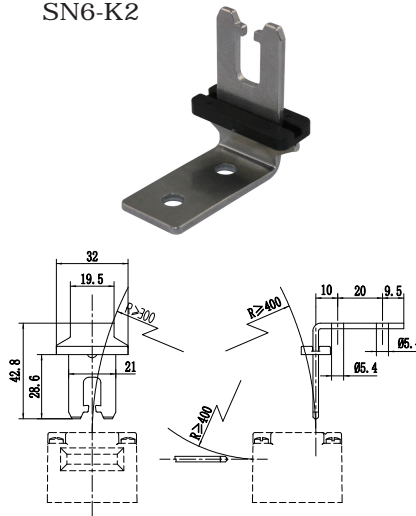

SN6-K3

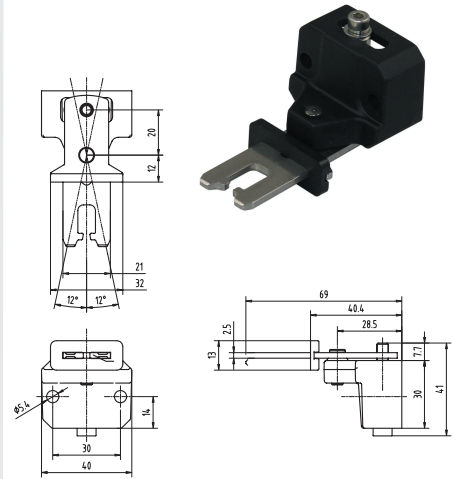

SN6-K4

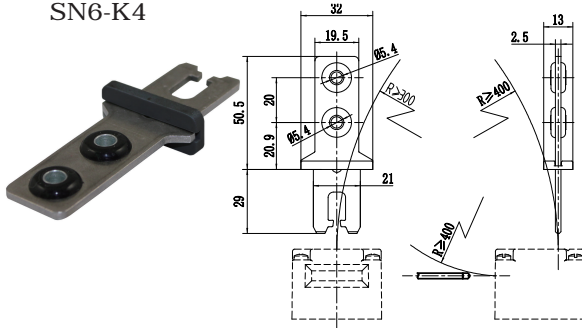

SN6-K5

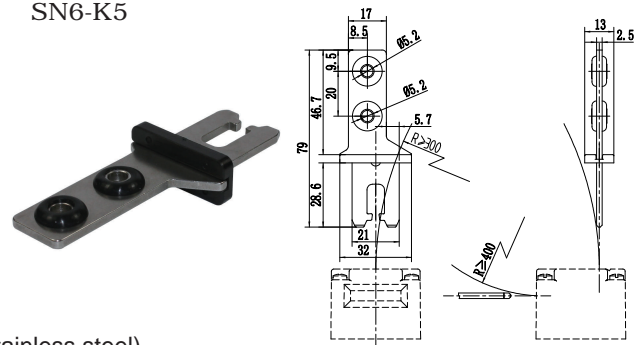

. For use with SN6,SS6191 and SSD6191 (Material: stainless steel)

SND-K1

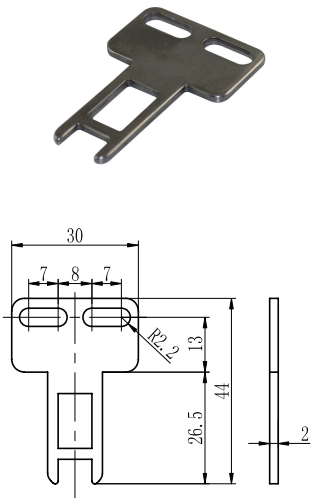

SND-K2

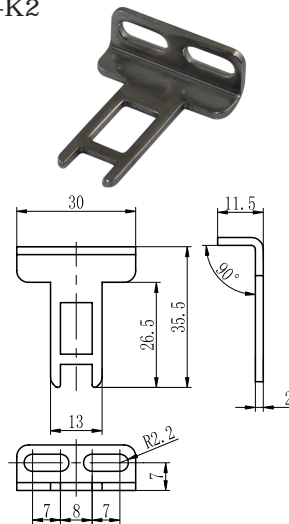

SND-K3

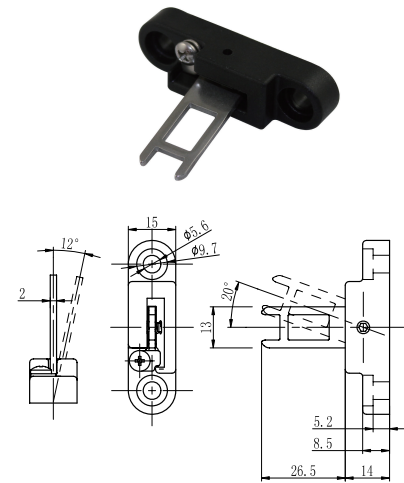

SND-K4

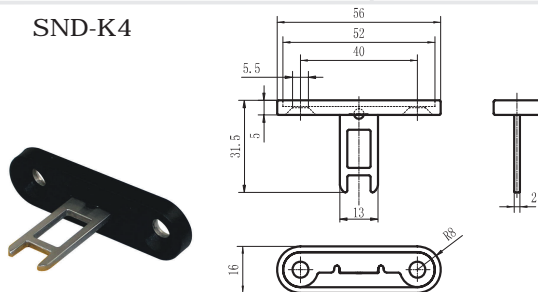

SND-K5

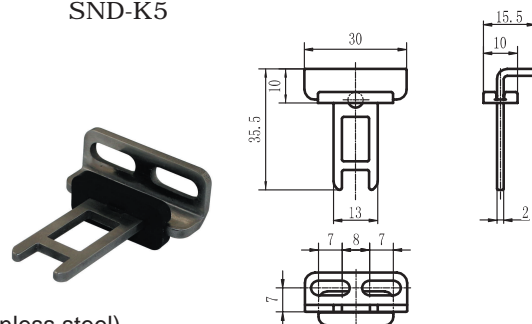

. For use with SND2, SND4, SMN4 and SND6 (Material: stainless steel)

SND4121 SERIES (SINGLE CONDUIT ENTRY)

Features

- Glass fiber reinforced plastic body
- Easily interchangeable contact block
- Galvanically separated contacts
- Screw terminals with self-lifting clamps for easy wiring
- Positive opening of NC contacts
- 4 x 90° actuator positions
- Cable entry available: M20, PG13.5 and 1/2"NPT
- Conform to EN 50047 standard

Definitions of Operating Characteristics

- OF Operating Force
 RF Releasing Force
 OT Overtravel
 TT Total Travel
 PT Pretravel
 MD Movement Differential
 OP Operating Position
 PO Travel to Positive Opening



Specifications

Operating Speed	0.05mm-2m/sec
Operating Frequency	Mechanical: 120ops/min Electrical: 30 ops/min
Insulation Resistance	>100MΩ@500V DC
Contact Resistance	<25mΩ (initial value)
Rated Current/Voltage	10A/600V AC (EN60947-5-1) AC15 A600 / DC13 Q300
Dielectric Strength	1000VAC for 1 min between current carrying parts 2500VAC for 1 min between non-current carrying parts
Service Life	Mechanically 1 x 10 ⁷ (operations) Electrically 5 x 10 ⁵ (operations)
Operating Temperature	-25~+80°C (-13~176°F) with no icing
Humidity	< 95%
Weight	50-100g
Degree of Protection	IP65/ IP67

